

Installation Instructions

1928-1931 FORD Rear Triangulated 4-Link Kit

*Please read these instructions completely **BEFORE** starting your installation!*

Your HEIDTS Hot Rod Shop 4-Link Kit contains the following items:

- | | |
|--------------------------|-------------------------|
| 2) Axle Brackets | 4) Axle Tabs |
| 2) Upper 4-Link Brackets | 4) Adjustable Link Bars |
| 2) Lower 4-Link Brackets | 1) 4-Link Hardware Kit |

(NOTE: Coil-over Shocks and Upper Mounts and Hardware are Optional)

1. Begin by installing the Axle Brackets onto the housing. They are located 37" apart, as shown in Figure 1, and on the 2° angle shown in Figure 2, which is the pinion angle. Your pinion angle may not be 2°, but it must be determined at this time. Make sure that both Brackets are the same distance from the ends of the axle housing. The Axle Brackets should be tack welded to the housing, and the assembly double checked for square and correct pinion angle.

2. Install the Lower Frame Brackets onto the underside of the frame at the 2-1/4" dimension from the top running board bracket hole. Tack weld in place. See Figure 3. Note that this kit is designed for a fully boxed frame. Frame should be boxed at least 6" forward of the Lower Mounts and all the way to the rear. Position the axle housing in the frame using the Lower Link Bars with the adjusters to the front and set the pinion angle to match the angle of the engine which should place the rear coil-over mounts vertical. Use the 5/8-18 bolts and lock nuts supplied.

3. Assemble the Upper Link Bars with the adjusters to the front onto the Front Brackets and Axle Tabs. Position the Tabs on the axle housing with the bushing centers approximately 2" forward of the axle center as shown in Figure 3 and 17" apart as shown in Figure 4. The Front Brackets should be approx. 1" below the top of the frame as shown in Figure 3. Tack weld in place. Check for floor pan clearance before final welding. If all is in place correctly, remove the Link Bars and finish weld all brackets. Final welding should be performed by a qualified welder.

4. The pinion angle can be fine adjusted using the Lower Link Bars, see Figure 5. Install the optional upper coil-over shock mounts per their instructions, and install coil-overs onto the mounts and axle housing brackets using a coil-over hardware installation kit.

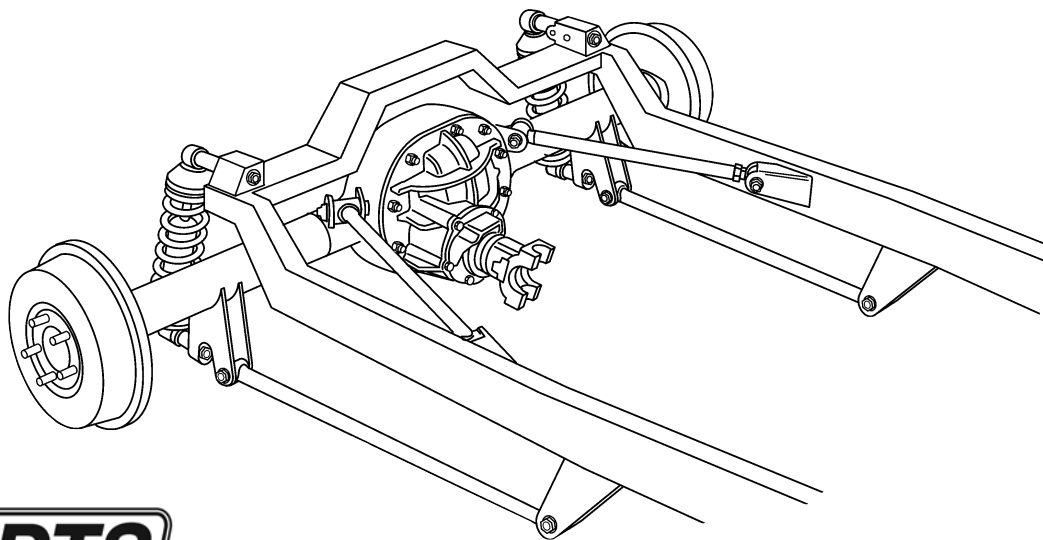

Installation Instructions

1928-1931 FORD Rear Triangulated 4-Link Kit

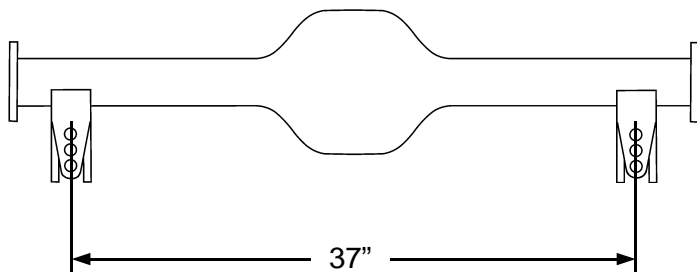

Figure 1

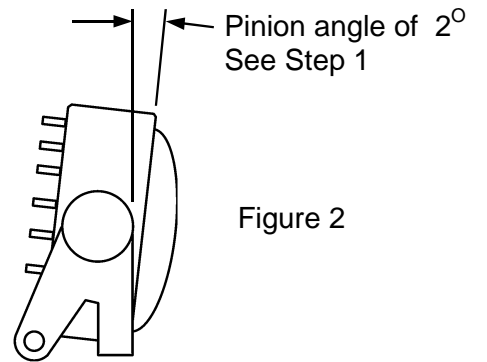

Figure 2

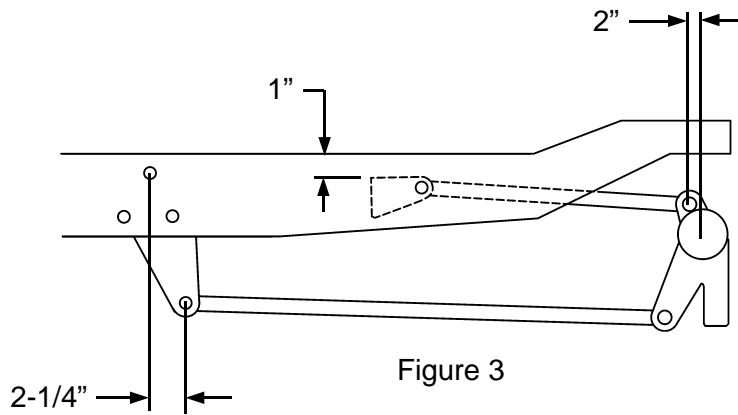

Figure 3

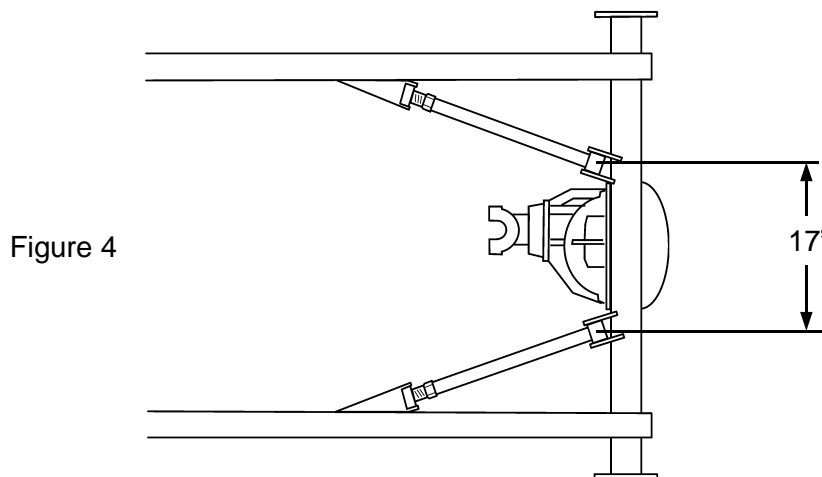

Figure 4

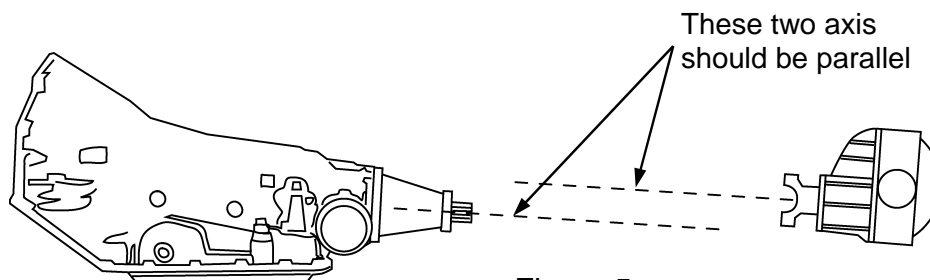

Figure 5